

Being a redivision of part of the Northeast 1/4 of the Northwest 1/4 of Section 15, Township 3 North, Range 21 East, in the Village of Yorkville, Racine County, Wisconsin.

M\CERTIFIED SURVEY MAPS\Yorkville(Village)\115795 (Schauf)\115795-CSM0.dwg

CERTIFIED SURVEY MAP NO. _____

Being a redivision of part of the Northeast 1/4 of the Northwest 1/4 of Section 15, Township 3 North, Range 21 East, in the Village of Yorkville, Racine County, Wisconsin.

SURVEYOR'S CERTIFICATE

I, Dennis C. Sauer, Professional Land Surveyor, do hereby certify:

That I have surveyed, divided and mapped a redivision of part of the Northeast 1/4 of the Northwest 1/4 of Section 15, Township 3 North, Range 21 East, in the Village of Yorkville, Racine County, Wisconsin; bounded and described as follows: Commencing at the Northeast corner of said Northwest 1/4; thence S 01°30'25" E along the East line of said Northwest 1/4, 53.00 feet to a point on the south right-of-way line of Plank Road (C.T.H. "A") and it's extension thereof; thence S 88°46'59" W along said extended right-of-way line, 33.00 feet to the point of beginning of the lands to be described; thence S 01°30'25" E, 1261.54 feet; thence S 88°37'40" W, 1286.40 feet; thence N 01°34'36" W, 1273.02 feet to a point on the south right-of-way line of Plank Road (C.T.H. "A"); thence N 88°46'59" E along said right-of-way line, 737.97 feet thence S 01°30'25" E, 200.00 feet; thence N 88°46'59" E, 200.00 feet; thence S 01°30'25" E, 58.08 feet; thence N 88°46'59" E, 154.99 feet; thence N 01°30'25" W, 258.08 feet to a point on the south right-of-way line of Plank Road (C.T.H. "A"); thence N 88°46'59" E along said south right-of-way line, 18.72 feet; thence S 01°30'25" E along said south right-of-way line, 8.00 feet; thence N 88°46'59" E along said south right-of-way line, 176.28 feet the point of beginning. Said lands containing 1,554,949 square feet (35.70 acres).

That I have made such survey, land division and map by the direction of Donald R. Schauf & Linda S. Schauf Revocable Living Trust Dated 12/7/2023, owner of said land.

That such map is a correct representation of all the exterior boundaries of the land surveyed and the land division thereof made.

That I have fully complied with the provisions of Chapter 236.34 of the Wisconsin State Statutes and Chapter 28 of the Certified Survey Map Ordinance of the Village of Yorkville in surveying, dividing and mapping the same.

June 10, 2025
Date

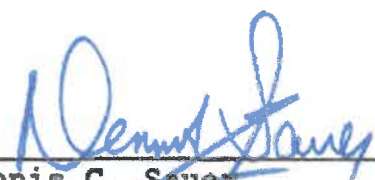

Dennis C. Sauer
Professional Land Surveyor S-2421

PREPARED FOR:
Donald R. Schauf & Linda S. Schauf
Revocable Living Trust Dated 12/7/2023
16509 Plank Road
Union Grove, WI 53182

PREPARED BY: Dennis C Sauer
Metropolitan Survey Service, Inc.
8482 South 76th Street
Franklin, WI 53130

CERTIFIED SURVEY MAP NO. _____

Being a redivision of part of the Northeast 1/4 of the Northwest 1/4 of Section 15, Township 3 North, Range 21 East, in the Village of Yorkville, Racine County, Wisconsin.

OWNER'S CERTIFICATE

Donald R. Schauf & Linda S. Schauf Revocable Living Trust Dated 12/7/2023, as owner, does hereby certify that it has caused the land described on this map to be surveyed, divided, mapped and dedicated as represented on this map in accordance with the provisions of Chapter 236.34 of the Wisconsin State Statutes and Chapter 28 of the Certified Survey Map Ordinance of the Village of Yorkville.

WITNESS the hand and seal of said owners this 13th day of June, 2025.



Donald R. Schauf, Trustee

Linda S. Schauf, Trustee

STATE OF WISCONSIN)
RACINE COUNTY) SS

PERSONALLY came before me this 13th day of June, 2025, Donald R. Schauf and Linda S. Schauf, Trustees, to me known to be the persons who executed the foregoing instrument and acknowledged the same.

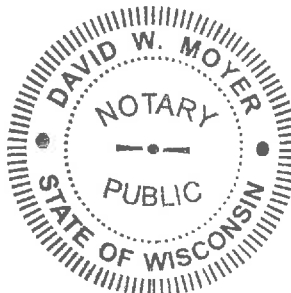
Notary Public-State of Wisconsin
My Commission Expires: 1-26-26



PLAN COMMISSION APPROVAL

APPROVED by the Plan Commission of the Village of Yorkville on this _____ day of _____, 20____.

Douglas Nelson, Chairperson

Barbara Geschke, Commissioner

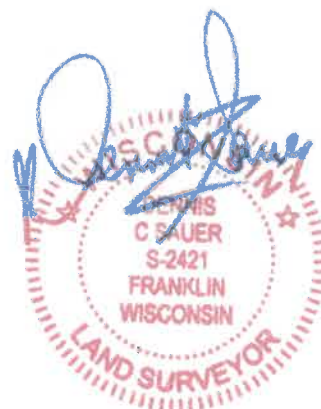

THIS INSTRUMENT WAS DRAFTED BY:
Dennis C. Sauer, P.L.S. S-2421

June 10, 2025